

## ■ PRESSURE SELF SEALING CHECK VALVE

### Material List

Part name	Standard material	Low temperature environment	Stainless steel material	High temperature environment	Acidic environment
Body	ASTM A216 WCB	ASTM A351 CF8M	ASTM A352 LCC	ASTM A217 WC9	ASTM A216 WCB
Seat ring	ASTM A105N+STL.6	ASTM A182 F316	ASTM A350 LF2+STL.6	ASTM A182 F22+STL.6	ASTM A105N+STL.6
Clack	ASTM A216 WCB+Cr13	ASTM A351 CF8M	ASTM A352 LCC+Cr13	ASTM A217 WC9+Cr13	ASTM A216 WCB+Cr13
Hinge	ASTM A216 WCB	ASTM A351 CF8M	ASTM A352 LCC	ASTM A217 WC9	ASTM A216 WCB
Gasket	Stainless steel/Graphite	Stainless steel/Graphite	Stainless steel/Graphite	Stainless steel/Graphite	Stainless steel/Graphite
Pin	ASTM A182 F6a	ASTM A276 316	ASTM A276 304	ASTM A276 304	ASTM A276 410(NACE)
Disc nut	ASTM A276 410	ASTM A276 316	ASTM A276 304	ASTM A276 304	ASTM A276 410(NACE)
Rod collar	ASTM A276 410	ASTM A182 F316	ASTM A182 F304	ASTM A182 F304	ASTM A182 F6a(NACE)
Axle pin	ASTM A182 F6a	ASTM A182 F316	ASTM A182 F304	ASTM A182 F304	ASTM A182 F6a(NACE)
Baffle plate	ASTM A276 410	ASTM A182 F316	ASTM A182 F304	ASTM A182 F304	ASTM A182 F6a(NACE)
Cover	ASTM A105N	ASTM A182 F316	ASTM A350 LF2	ASTM A182 F22	ASTM A105N
* Sealing ring	SS304+ Graphite	SS316+ GRAPHITE	SS304+ Graphite	SS304+ Graphite	SS304+ Graphite
Locating ring	ASTM A276 410	ASTM A182 F316	ASTM A182 F304	ASTM A182 F304	ASTM A276 420(NACE)
Bonnet nut	ASTM A194 2H	ASTM A194 8	ASTM A194 7	ASTM A194 4	ASTM A194 2HM
Bolt	ASTM A193 B7	ASTM A193 B8	ASTM A320 L7	ASTM A193 B16	ASTM A193 B7M



**■ PRESSURE SELF SEALING CHECK VALVE**

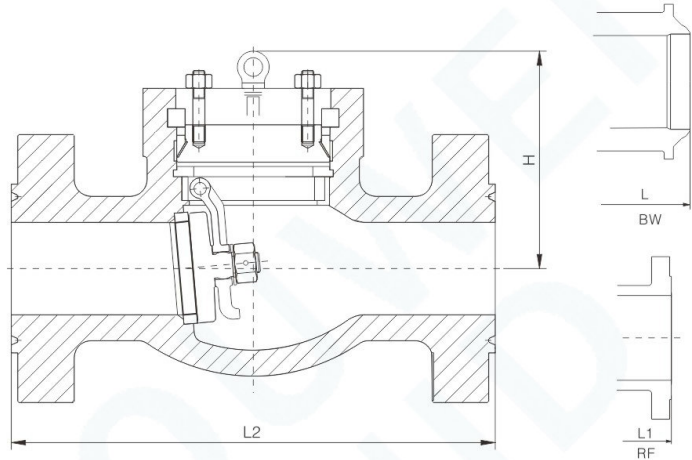

**Main Dimensions**

**Class 600LB**

NPS	in	2"	2-1/2"	3"	4"	5"	6"	8"	10"	12"	14"	16"	18"	20"	24"	26"	28"	30"
DN	mm	50	65	80	100	125	150	200	250	300	350	400	450	500	600	650	700	750
L(BW)	in	7	8.5	10	12	15	18	23	28	32	/	/	/	/	/	/	/	/
	mm	178	216	254	305	381	457	584	711	813	/	/	/	/	/	/	/	/
L1(RF)	in	12	13	14	17	20	22	26	31	33	35	39	43	47	55	57	63	65
	mm	292	330	356	432	508	559	660	787	838	889	991	1092	1194	1397	1448	1549	1651
L2(RTJ)	in	12	13	14	17	20	22	26	31	33	35	39	43	47	55	58	64	66
	mm	295	333	359	435	511	562	663	790	841	892	994	1095	1200	1407	1461	1562	1664
H	in	10	10	11	13	16	16	23	24	27	30	30	29	32	37	39	43	47
	mm	241	264	268	318	399	399	587	607	696	749	729	730	819	950	1000	1099	1200
WT(RF)	kg	27	35	45	85	135	190	350	500	670	880	1150	1480	1880	2600	3100	3500	4000
WT(BW)	kg	18	25	32	55	85	130	260	370	490	660	850	1100	1490	2040	2500	2800	3150

**Main Dimensions**

**Class 900LB**

NPS	in	2"	2-1/2"	3"	4"	6"	8"	10"	12"	14"	16"	18"	20"	24"	26"	28"	30"
DN	mm	50	65	80	100	150	200	250	300	350	400	50	500	600	650	700	750
L(BW)	in	9	10	12	14	20	26	31	36	39	43	48	52	61	63	67	71
	mm	216	254	305	356	508	660	787	914	991	1092	1219	1321	1549	1600	1702	1803
L1(RF)	in	15	17	15	18	24	29	33	38	41	45	48	52	61	65	69	73
	mm	368	419	381	457	610	737	838	965	1029	1130	1219	1321	1549	1651	1753	1854
L2(RTJ)	in	15	17	15	18	24	29	33	38	41	45	49	53	62	66	70	74
	mm	371	421	384	460	613	740	841	968	1039	1140	1232	1334	1568	1673	1775	1877
H	in	10	10	10	13	13	23	24	21	30	28.7	34	34	38	39	42	55
	mm	241	264	265	318	325	587	607	533	749	729	851	864	959	1000	1073	1400
WT(RF)	kg	42	55	58	110	242	599	893	1365	1628	1733	2300	3000	4100	4600	5200	6000
WT(BW)	kg	21	32	34	68	168	462	725	1071	1281	1418	1850	2400	2900	3600	4000	4600

## ■ PRESSURE SELF SEALING CHECK VALVE

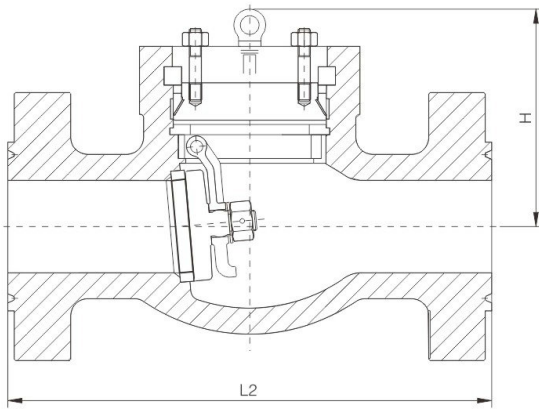

Class1500

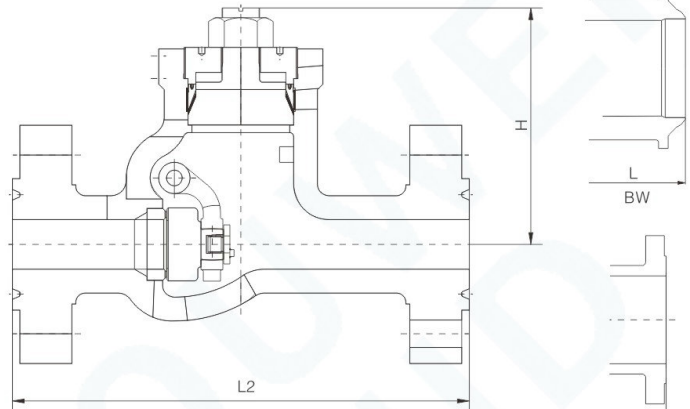

Class 2500

### Main Dimensions

### Class1500LB

NPS	in	2"	2-1/2"	3"	4"	6"	8"	10"	12"	14"	16"	18"	20"	24"
DN	mm	50	65	80	100	150	200	250	300	350	400	50	500	600
L(BW)	in	9	10	12	16	22	28	34	39	42	47	53	58	77
	mm	216	254	305	406	559	711	864	991	1067	1194	1345	1473	1943
L1(RF)	in	15	17	185	22	28	33	39	45	50	54	61	66	77
	mm	368	419	470	546	705	832	991	1130	1257	1384	1537	1664	1943
L2(RTJ)	in	15	17	19	22	28	33	39	45	50	55	61	66	78
	mm	371	422	473	549	711	842	1001	1146	1276	1406	1559	1686	1971
H	in	10	10	11	14	13	18	20	25	28	30	35	37	43
	mm	241	264	280	363	337	450	513	645	711	749	880	949	1099
WT(RF)	kg	42	58	105	147	360	641	1103	1628	2205	2730	3300	4200	6000
WT(BW)	kg	21	34	42	74	233	504	777	1155	1481	1680	2100	2600	3500

### Main Dimensions

### Class2500LB

NPS	in	2"	2-1/2"	3"	4"	6"	8"	10"	12"	14"	16"	18"	20"	24"
DN	mm	50	65	80	100	150	200	250	300	350	400	50	500	600
L(BW)	in	11	13	15	18	24	30	36	41	44	49	55	61	68
	mm	279	330	368	457	610	762	914	1041	1118	1245	1397	1549	1727
L1(RF)	in	18	20	23	27	36	40	50	56	/	/	/	/	/
	mm	451	508	578	673	914	1022	1270	1422	/	/	/	/	/
L2(RTJ)	in	18	20	23	27	37	41	51	57	/	/	/	/	/
	mm	454	514	584	683	927	1038	1292	1444	/	/	/	/	/
H	in	10	10	12	13	18	22	23	26	34	35	39	45	55
	mm	245	264	303	318	452	559	577	655	861	899	1000	1149	1400
WT(RF)	kg	89	124	163	299	588	1071	1676	2772	/	/	/	/	/
WT(BW)	kg	53	74	89	142	286	598	783	1512	2450	3200	4050	5000	7200